

| LIGHT FIXTURE SCHEDULE | | | |
|------------------------|-----|-------------------------|---|
| SYMBOL | NO. | TYPE | REMARKS |
| | A | 1x4 FLOOR SURFACE MOUNT | ROYAL PACIFIC 4213 (2) 32W LAMPS |
| | B | INTERIOR CEILING GLOBE | MILLENNIUM LIGHTING 5425N (1) 60W LAMP |
| | C | WALL MOUNT INTERIOR | MILLENNIUM LIGHTING 4835N (3) 100W LAMPS |
| | D | WALL MOUNT EXTERIOR | TRANS GLOBE PL-4800 BLACK (1) 28W LAMP |
| | EF | EXHAUST FAN | SEE SHEET M-2.1 |
| | EM | EMERGENCY LIGHT | COOPER LIGHTING 4425S BATTERY PACK LAMPS INCLUDED |
| | G | CEILING FAN (BEDROOM) | ROYAL PACIFIC 1059-S-L BUILDER DELUX |
| | H | RECESSED CAN | TRAC HTRC 301P TRM (1) 75W INCAND. |
| | J | CEILING FAN (LIVING RM) | ROYAL PACIFIC 1059-SH-L BUILDER DELUX |

| ELECTRICAL LEGEND | |
|-------------------|--|
| | DUPLEX OUTLET AT 18" AFF |
| | WEATHER PROOF DUPLEX OUTLET AT 18" AFF |
| | DUPLEX OUTLET W/GROUND FAULT INTERRUPT |
| | DUPLEX OUTLET AT 48" AFF |
| | CABLE TV OUTLET (EXTEND CABLE TO EXTERIOR BOX) |
| | TELEPHONE OUTLET (EXTEND WIRING TO EXTERIOR BOX) |
| | ELECTRICAL PANEL |
| | SINGLE POLE FAN/LIGHT TOGGLE SWITCHES |
| | SINGLE POLE TOGGLE SWITCH |
| | 3-WAY TOGGLE SWITCH |
| | ELEC. DISCONNECT |
| | DOOR BELL |
| | DOOR CHIME |

ELECTRICAL RISER DIAGRAM

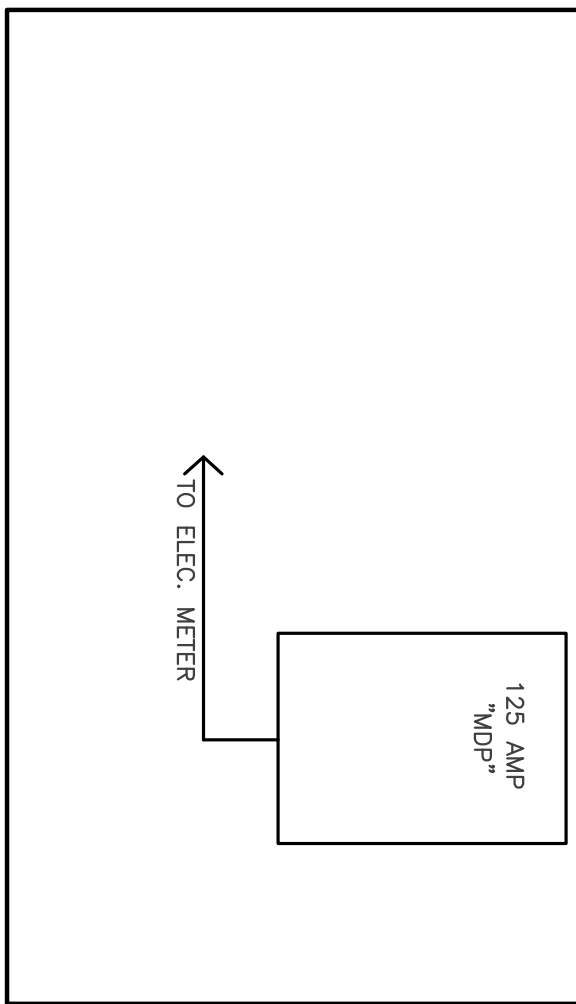

NOTE:
FIRE ALARM AND SMOKE DETECTION SYSTEM
REQUIRED FOR EACH UNIT

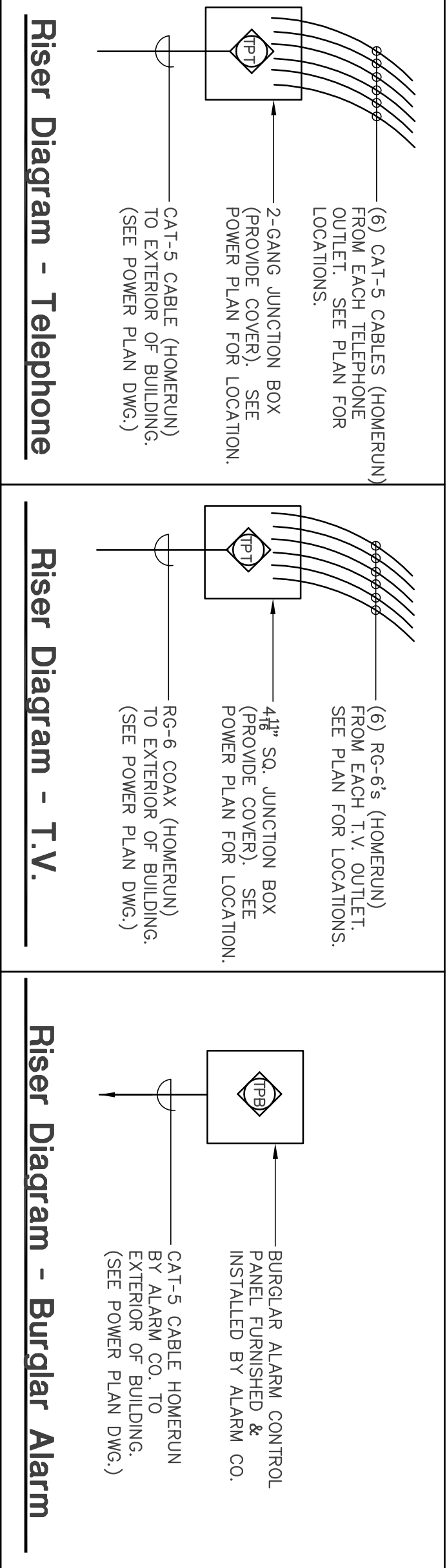

NOTE:

- FIRE ALARM AND SMOKE DETECTION SYSTEM REQUIRED FOR EACH UNIT.
- THE INTRUSION ALARM WILL BE FURNISHED AND INSTALLED BY THE OWNER
- THE MOTION DETECTOR AND KEY PAD WILL BE INSTALLED BY AN ALARM SUBCONTRACTOR.
- PROVIDE A TELEPHONE LINE FROM THE ALARM BOX TO THE TELEPHONE BOX LOCATED ON THE EXTERIOR OF THE BUILDING.
- THE SMOKE DETECTORS AND SMOKE/HEAT DETECTORS WILL BE INSTALLED BY THE ELECTRICAL SUB-CONTRACTOR PER CODE.
- THE SMOKE/HEAT/CARBON MONOXIDE DETECTOR SYSTEM IS TO BE A STAND-ALONE SYSTEM FOR EACH APARTMENT.

THE FOLLOWING APPLIANCES WILL BE PROVIDED FOR EACH APARTMENT:

REFRIGERATOR - G.E. # GTH8CQW 181 CU. FT. WITH ICEMAKER
RANGE - G.E. # JBS07MWW 30" FREE STANDING
MICROWAVE / HOOD - G.E. # JMT154DWW VENTLESS
DISHWASHER - G.E. # G3SD3300RW
GARBAGE DISPOSAL - INSINKERATOR 1/3 HP

THE FOLLOWING APPLIANCE COROS WILL BE PROVIDED FOR EACH APPLIANCE:

REFRIGERATOR - ELEC. SUPPLY - 5' ICEMAKER WATER SUPPLY
RANGE - 4' 4-PRONG RANGE CORD # 4RC4
MICROWAVE / HOOD - ELEC. SUPPLY
DISHWASHER - ELEC. SUPPLY W/THREE-WIRE GROUNDING. MALE PLUG
GARBAGE DISPOSAL - ELEC. SUPPLY. (FURNISH SINK AND WIRE TO THE SINK AND WIRE TO ONE SIDE OF GF DUPLEX OUTLET LOCATED UNDER SINK CABINET)

Electrical Load Calculational Plan Typ. For 2-Bedroom Unit

| PANEL 125 ammp | |
|--|-----------|
| (2)-Bedrm. Unit) 1047 Sq. Ft. @ 3va | 3,141 VA |
| (2) 20A APPLIANCE CIR @ 1500VA | 3,000 VA |
| LAUNDRY CIR | 1,500 VA |
| RANGE (NAMEPLATE) | 8,000 VA |
| WATER HEATER | 3,500 VA |
| DISHWASHER | 1,200 VA |
| | 5,000 VA |
| | 25,341 VA |
| 1st 10KVA @ 100% = 10,000 VA | |
| REMAINDER @ 40% = 6,136 VA | |
| TOTAL GENERAL LOAD = 16,136 VA | |
| HEAT PUMP = 2,880 VA | |
| 2880VA + 8000(65%) = 8,090 VA | |
| TOTAL = 27,106 VA | |
| TOTAL = 27,106 VA / 240 VOLTS = 112.9 AMPS | |
| 125 AMP SERVICE | |

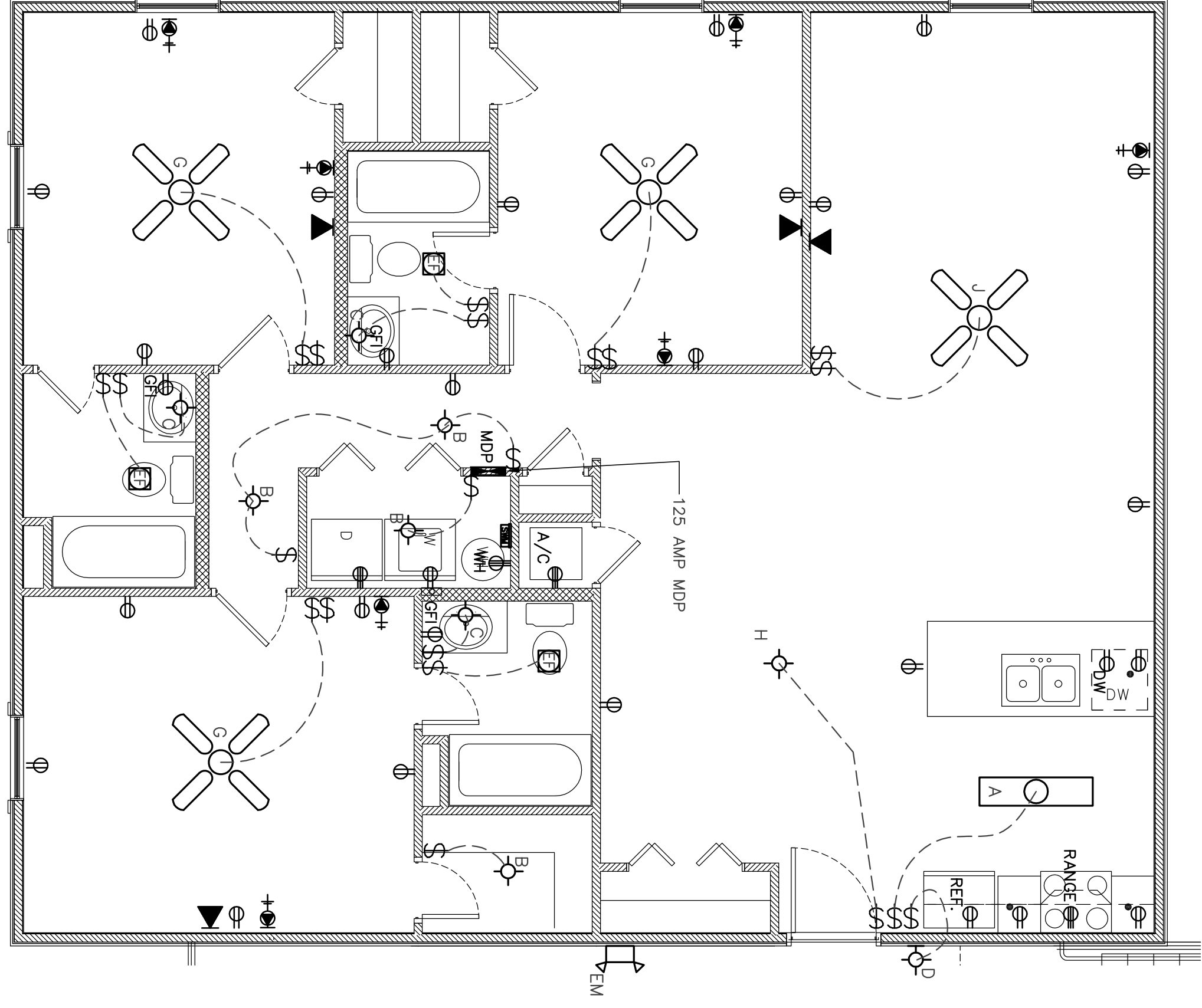

Typical 3-Bedroom Unit - Bldg. "A" - 2nd & 3rd Floors Typical 3-Bedroom Unit - Bldg. "B" - 1st, 2nd & 3rd Floors

OPPOSITE APARTMENT SIMILAR
EXCEPT REVERSE HAND

Scale: 1/4" = 1'-0"

ALARM LEGEND

- KEY PAD
- SMOKE DETECTOR
- SMOKE/HEAT DETECTOR
- SMOKE/CARBON MONOXIDE COMBO DETECTOR

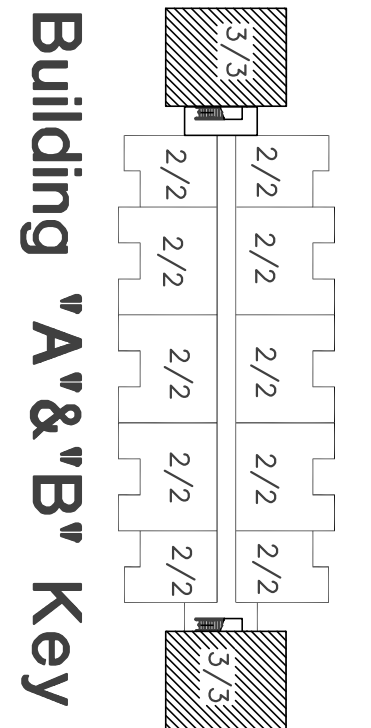

A New Apartment Complex
For
Remerton Mill Apartments
1853 W. Gordon Street Remerton, Georgia

JAMES D. CONE
ARCHITECT
1806 PLUM STREET VALDOSTA, GA. 31601 TELE (229) 247-8378 FAX (229) 245-9311 E-mail JIMMY_CMA@BELLSOUTH.NET

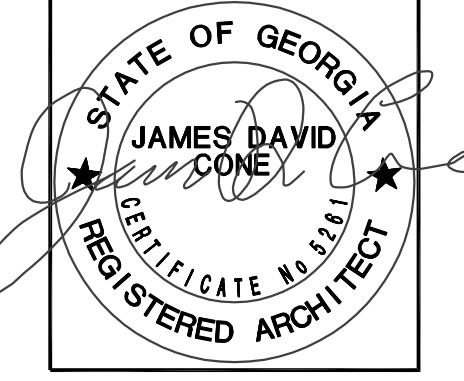

DRAWING NUMBER
E-1.1
SHEET 35 OF 47
DRAWN: [Name] / [Date]
CHECKED: [Name] / [Date]
JOB NUMBER: 12-00
DATE: June 5, 2018
REVISIONS:
THESE REVISIONS ARE THE PROPERTY OF JAMES D. CONE ARCHITECT. NO REPRODUCTION OR TRANSMISSION AND/OR CREDIT