

Plumbing Plan - Building 'B' 2nd. & 3rd Floor  
Scale: 1/8" = 1'-0"

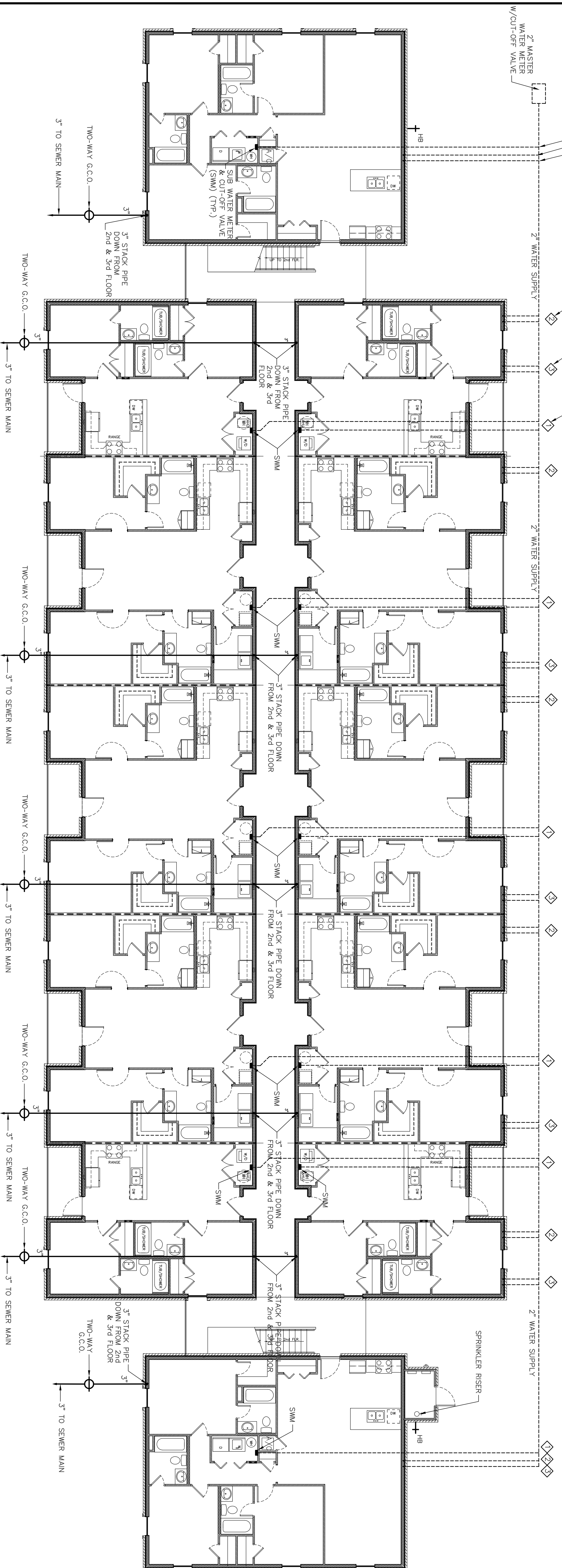

Plumbing Plan - Building 'B' 1st Floor  
Scale: 1/8" = 1'-0"

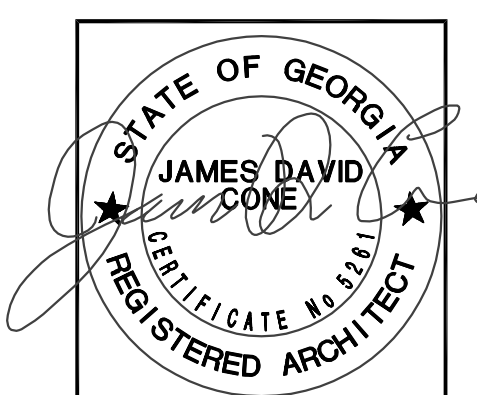

**JAMES D. CONE**  
ARCHITECT

1806 PLUM STREET VALDOSTA, GA. 31601 TELE (229) 247-8378 FAX (229) 245-9311 E-mail JIMMY\_CMA@BELLSOUTH.NET

**A New Apartment Complex**  
For  
**Remerton Mill Apartments**  
1853 W. Gordon Street  
Remerton, Georgia

DRAWING NUMBER  
**P-2.3**  
SHEET 33 OF 47

DATE: 11-20-06  
JOB NUMBER: 17-00  
CHECKED: JDC  
DRAWN: MJC

REVISIONS:  
1. 11-20-06: PERMITTED BY THE PROPERTY REPRESENTATIVE TO BE SUBMITTED FOR PERMITS AND CLIENT.